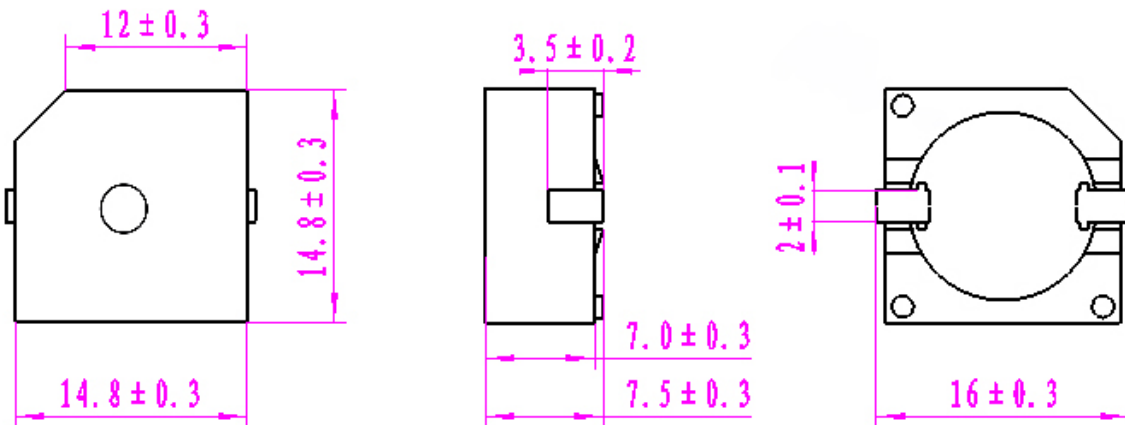
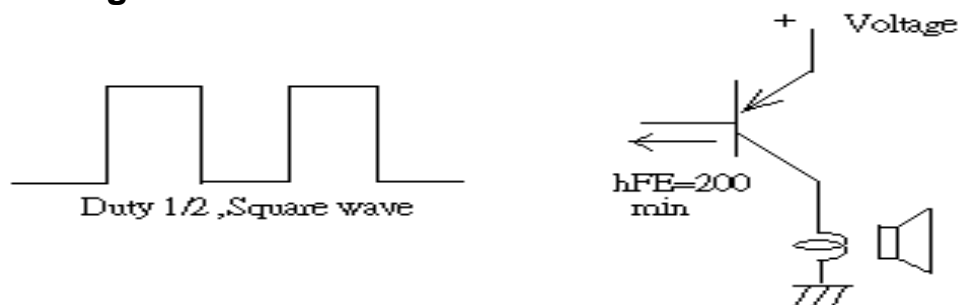

**Sales Outline Drawing**Revision **B****Specifications:**

|                                    |                                   |
|------------------------------------|-----------------------------------|
| Oscillation Frequency (Hz)         | 3650 ± 500                        |
| Operating Voltage (Vp-p)           | 1 ~ 30                            |
| Rated Voltage (Vp-p)               | 7.0                               |
| Current Consumption Max. (mA)      | 5 at Rated Voltage                |
| Sound Pressure Level (dB/min)      | 85 at 10cm at Rated Voltage       |
| Capacitance (pF)                   | 15,000 ± 30% at 120 Hz            |
| Operating Temperature (°C)         | -30 ~ +70                         |
| Storage Temperature (°C)           | -40 ~ +80                         |
| Type of Connection Terminal        | SMD                               |
| Housing                            | PPS plastic resin (Color : Black) |
| Weight (Grams)                     | 2.0                               |
| Condition by reflow soldering (°C) | 245 ± 5 / 1 min                   |
| Condition by hand soldering (°C)   | 350 ± 20 / within 5 sec           |
| Options                            | For other options contact factory |

**Dimensions:** (units: mm)**PS:** Vp-p=1/2duty, square wave**RoHS Compliant****Recommend Driving Circuit****Packaging:**

Parts are supplied on reels (600 pcs per tape and reel).

Units do not come with wash label and are not appropriate for aqueous wash.